

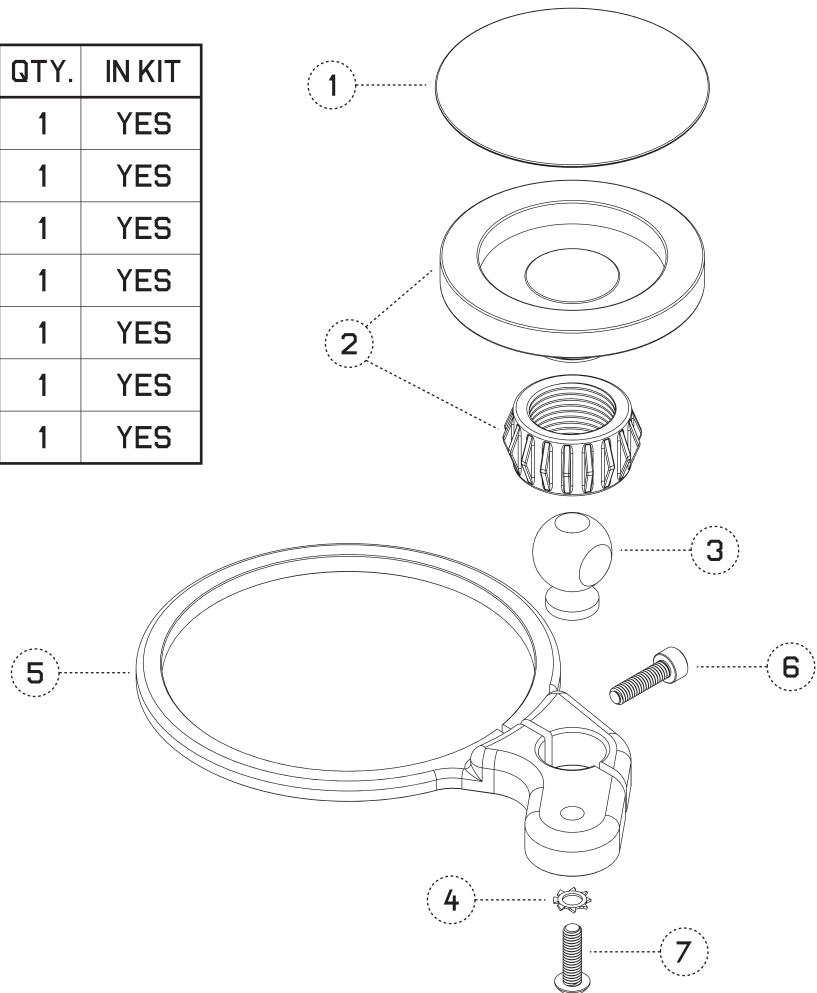

CLOCK BEZEL PHONE HOLDER

ITEM	PART NAME	QTY.	IN KIT
1	STEEL PLATE	1	YES
2	MEGNETIC ASSEMBLY	1	YES
3	ALUMINUM BALL	1	YES
4	TOOTH LOCK WASHER	1	YES
5	MOUNTING BRACKET	1	YES
6	SOCKET HEAD SCREW	1	YES
7	BUTTON HEAD SCREW	1	YES



READ BEFORE INSTALLATION

The use of any Asphalt Killerz product is the sole responsibility of the end user. Asphalt Killerz accepts no responsibility for warranty voids or damage resulting from the use of these products. Due to the varying location of wiring harnesses and other components, carefully inspect any area before drilling. All Asphalt Killerz products are intended for off-road use only and should be installed by a qualified automotive technician.

INSTALLATION

1. Install the aluminum ball onto the metal bracket as shown using the supplied screw.
2. Gently pull the clock out of the dash, just enough to separate the clock and gasket about 1/4". (photo 1)
3. Remove the clamp screw from the phone mount to allow the mount to be expanded. (photo 2)
4. Slide open the end of the mount over the bottom of the clock first, then work around towards the top of the clock until the mount snaps over the top of the clock. (photos 2 + 3)
5. Press the clock back into the dash. (photo 4)
6. Re-install the clamp screw to the mount. Adjust the mount as far right as possible without interfering with the dash while tightening. (photo 5)
7. Remove the lock nut from the magnetic pad assembly, and install the nut over the top of the aluminum ball with the threads pointing out.
8. Snap the magnetic pad assembly over the aluminum ball and secure it by tightening the lock nut. (photo 6)
9. Attach the metal plate to your phone case or phone. If you have a thick phone case, we recommend applying the metal plate to the outside of the phone case for maximum magnetic pull.
10. Attach the phone to your mount.
11. Enjoy your new Rennline product.



CLOCK BEZEL PHONE HOLDER

photo 1



photo 2



photo 3



photo 4



photo 5



photo 6



About the metal ring

Work for iPhone 15/14/13/12 & MagSafe Case

Works Directly



Other phones or cases need to stick the metal ring

Work with Metal Ring



Metal Ring Installation Steps

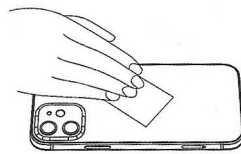

Clean the back of the phone or the case.

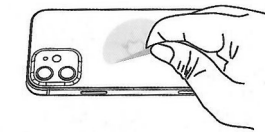

Stick the round transparent sticker in the center of the phone.

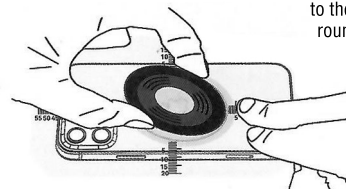

Stick the metal ring to the center of the round transparent sticker.

Sticky Base - About Time

Wait 24 hours for adhesive to maximize the sticky.

