



DOOR HANDLE PULLS

How to use slot template



Utilize a craft knife or scissors to carefully cut out each slot or template.



Only four tabs remain that require cutting along the existing pre-cuts.

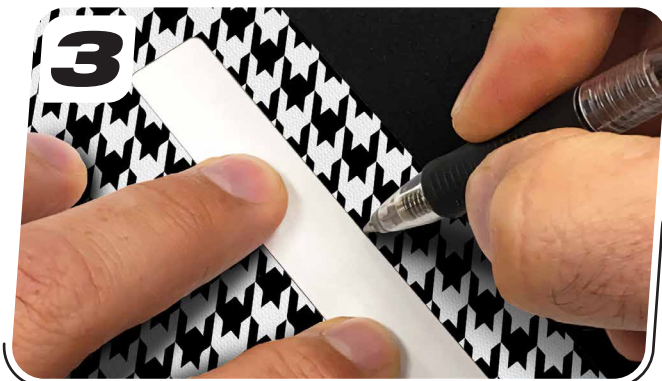

Outline the template on your elected fabric or vinyl.



Once you are satisfied with the placement and the traced line, proceed to cut it out.



DOOR HANDLE PULLS

How to use slot template

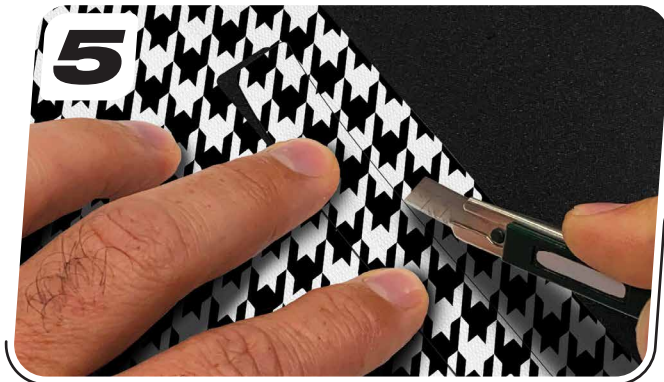

Employ a craft knife or scissors to remove each traced template.

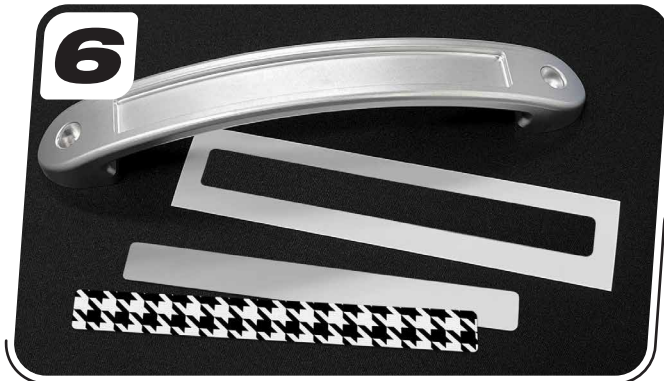

You can now insert the cut-out piece into its designated slot.

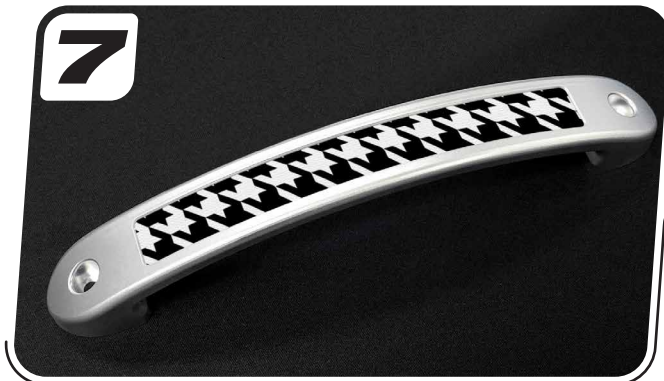

Apply adhesive to your material, position it, press down, and you're finished!

If you ever wish to change the material or fabric pattern of your handlebar slot, here's a template for you. Simply print it, cut it out, and you're all set for your new DIY project.

**ASPHALT
KILLERZ**

